

PROJECT:-

**G+III (12.50 M. HIGHT) STORIED RESIDENTIAL BUILDING PLAN
U/S 339A OF K.M.C. ACT 1980 AND K.M.C BUILDING RULE 2009
AT PREMISES NO - 25/10, K.P. ROY LANE UNDER K.M.C.
WARD NO - 92,. BOROUGH - X, P.S. - GARFA, KOLKATA - 700031,
UNDER KOLKATA MUNICIPAL CORPORATION**

NAME OF THE APPLICANT :- SRI SINCHAN SINHA
DIRECTOR OF "SINCHAN ASSOCIATE PVT. LTD."
AND CONSTITUTED ATTORNEY OF
SMT PRANATI DEBNATH & SRI MANIK RANJAN DEBNATH



LATITUTDE - 22° 30' 08" N
LONGITUDE - 88° 22' 45" E

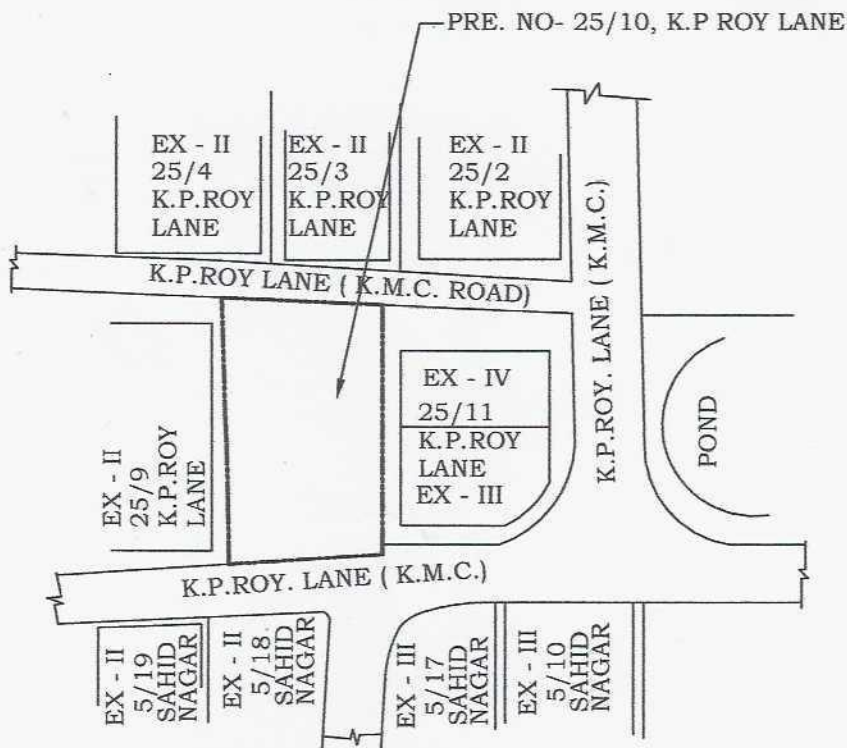

SITE PLAN
SCALE - 1:600

SINCHAN ASSOCIATE PVT. LTD.

Director

SIGNATURE OF OWNER / APPLICANT